

ABERNATHY and ASSOCIATES

Kenneth B. Abernathy Jr.

Wisconsin Registered Land Surveyor S-1594

W4056 Bray Road  
Elkhorn, Wisconsin 53121  
Phone: (414) 723-4260 (office)  
(414) 723-4813 (residence)

PLAT OF SURVEY

Lot 62 of Mariner Hills Subdivision,  
located in Section 34, Town 4 North, Range  
16 East, Town of La Grange, County of  
Walworth, State of Wisconsin.

Lot 11

Lot 10

Mariner Hills Circle

66' Wide  
R=165.00'  
A=55.05'

Underground  
Utility Boxes  
Corner falls on  
Electric Transformer  
Chisel Cross on cover

Blacktop  
Driveway

Garage

Residence

Wood  
Deck

Well

Septic

Septic  
Vent

Lot 61

Lot 63

Lot 62  
0.57 Acres ±

Owner: Carol Anderson

Ordered by: Paul Page

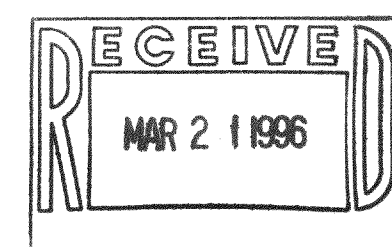

Legend

- FOUND IRON PIPE
- FOUND IRON ROD
- FOUND BRASS CAPPED MONUMENT
- FOUND CONCRETE MONUMENT
- CHISEL CUT IN CONCRETE
- SET IRON ROD, 24" LONG, WEIGHING 1.5 LBS./LINEAL FT., 3/4" DIA.
- SET IRON ROD, 30" LONG, WEIGHING 4.5 LBS./LINEAL FT., 1-11/16" DIA.
- RECORDED AS DIMENSION
- EXISTING FENCE

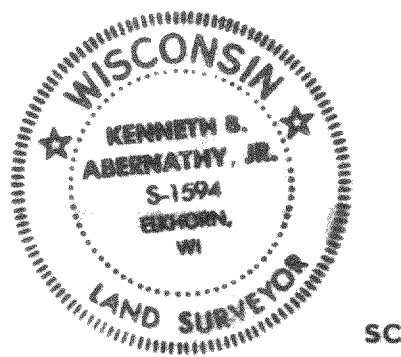

SCALE: 1"= 20 FEET

"I hereby certify that the above described property has been surveyed by me or under my direction and that the above map is a true representation thereof and shows the size and location of the property, its exterior boundaries, the location of all visible structures and dimensions of all principal buildings thereon, boundary fences, apparent easements, roadways and visible encroachments, if any. This survey is made for the use of the present owners of the property, and also those who purchase, mortgage, or guarantee the title thereto within one year from date hereof."

*Kenneth B. Abernathy, Jr.*  
KENNETH B. ABERNATHY, JR.  
WISCONSIN REGISTERED LAND SURVEYOR,  
S-1594

Date: September 9, 1993 Job No. 1988.902B

HMH-62  
H16-1201